

REV	DESCRIPTION	DATE	BY
A	NEW DRAWING	12/28/10	JAG

SKT3575

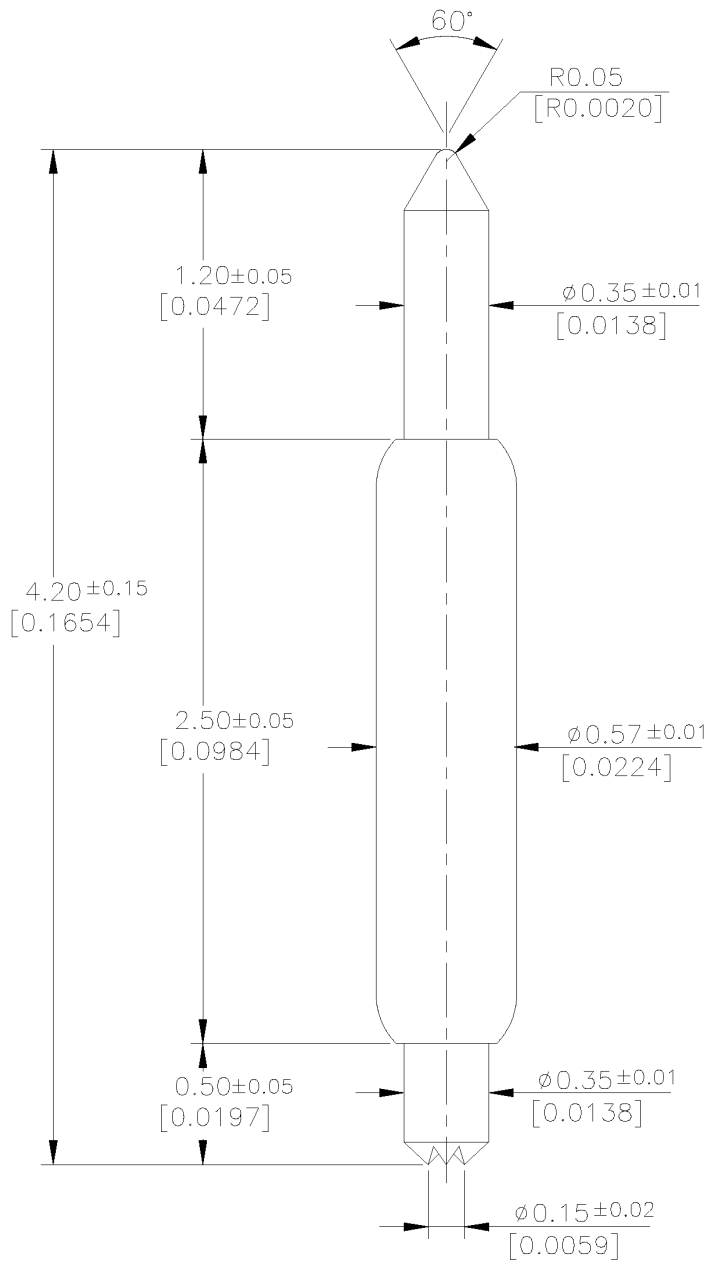

CRES: AVG 70mΩ

Pointing Accuracy: ± 0.06 mm

Spring Force [±20%]

8.2g (0.289oz) at initial travel

* 31.8g (1.122oz) at 0.70mm (0.0276) recommended travel

* 36.9g (1.302oz) at 0.85mm (0.0335) full travel

Material & Finish

Plunger-Top	Hardened Beryllium Copper	/ PdCo Plated
Plunger-Bottom	Hardened Beryllium Copper	/ Gold Plated
Barrel	Phosphor Bronze	/ Gold Plated
Spring	Music Wire	/ Gold Plated

* Notice: It is very important to verify the actual working travel when this probe is set in a socket due to the 0.15mm difference between *recommended* and *full* travel. If the actual working travel is over 0.85mm, the spring and/or plunger will be damaged.

DIMENSIONS ARE IN MM UNLESS OTHERWISE SPECIFIED TOLERANCES ARE:
 X.X ±0.100MM ANGULAR: X.X° ±1.0°
 X.XX ±0.050MM X.XX° ±0.5°
 X.XXX ±0.025MM

ALL DIMENSIONS ARE IN MILLIMETERS UNLESS OTHERWISE SPECIFIED

	EMULATION TECHNOLOGY, INC.	
	VLSI and SMT ADAPTERS and ACCESSORIES	
759 FLYNN ROAD CAMARILLO, CA 93012		TEL: (805) 383-8480 FAX: (805) 383-8484
SHEET: 1 OF 1	DATE: 12/28/10	REVISION: A
ASSEMBLY DRAWING		
CHECKED:	PREPARED BY: J. GELACIO	ITEM: POGO-PIN-4.20-1
DO NOT SCALE DRAWING		DESCRIPTION: POGO-PIN-4.20-1